

# HVW-27C Bluetooth® Communication Interface for HV-C/CP, HW-C/CP Instruction Manual

HVW-27C is a wireless communication option. Attach to the HV-C/CP and HW-C/CP series scale.

## 1. Installation Procedure

Note 1: Before installing the HVW-27C option board, remove the AC adapter from the power supply.

If the scale is C type, remove the batteries.

Note 2: If the scale is C type, the HVW-27C option board can be installed only on the OP-ch1.

If the scale is CP type, the HVW-27C option board can be installed only on the OP-ch1 or OP-ch2.

Step 1 Remove the two 3M screws at both side on the panel, and then remove the panel from the display unit.

Step 2 Connect the cable located inside the display unit to the connector on the option panel.

Step 3 Firmly secure the option to the display unit using the two M3 screws.

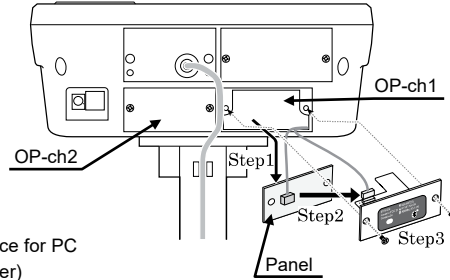

## 2. Connectable Device

- Smartphone/tablet via App : Install A&D WeiV® (App)
- AD-8931 : Wireless Remote Display
- AD-8541-PC : Wireless Communication Interface for PC (Connect to USB port of computer)

Note 1: Refer to the A&D website for details.

- Smartphone/Tablet/PC with Bluetooth

: Refer to "5. HID Function (HID Over GATT Profile)".

Note 2: Turn on DIP switch No.1. Refer to "3. DIP Switch".

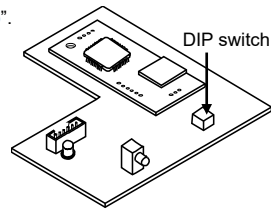

## 3. DIP Switch

Switch the DIP switch settings depending on the connected device.

From "2. Connectable Device":

For A&D WeiV/AD-8931/AD-8541-PC : Case 1

For tablet, etc. : Case 2

Note: To switch the DIP switch settings, use a rounded object such as the tip of a ballpoint pen to slide it.

Case	DIP switch		Output Data
	No.1	No.2	
	SELECT	SERIAL	
1	OFF	OFF	Connect to AD-8931 or AD-8541-PC or A&D WeiV
	SELECT ON SERIAL	1 2	
2	ON	OFF	Only numerical data (No header, no + sign and no unit) Example 1) 1.23 Example 2) -4.56 ↑ Data
	SELECT ON SERIAL	1 2	

## 4. Setting the Scale (HV-C/CP, HW-C/CP series)

Refer to the instruction manual of the scale (HV-C/CP, HW-C/CP series), to set the functions.

Note: When installed to the OP-ch1 of the C type or CP type scale, set the same settings as the following three functions.

When installed to the OP-ch2 of the CP type scale, set the internal settings ("bp5 2", "btp 2", "prt 2") same as the following three functions.

- Set function " bP5 I " to " 0 ".
- Set function " b t P I " to " 0 ".
- Set function " P r t I " to " 0 ". (In case of connection to AD-8931)

## 5. HID Function (HID Over GATT Profile)

- By turning on DIP switch No.1, you can connect to a Smartphone, tablet, or PC with Bluetooth and use a general-purpose text application or spreadsheet software.
- The output data has no header (ST, WT, etc.), + sign and unit (g, kg, etc.).
- Set the keyboard language of device to English.

### Pairing

- Turn on the Bluetooth function of connection device and power on the scale. Select the "A&D\_HID" device and pair. S/N may have been added after "A&D\_HID".
- You will not be able to connect if more than 30 seconds have passed without pairing after selecting the device. In that case, power off the scale and try again.

## 6. Precautions for Use

- Refer to the instruction manual of the connection device for the pairing.
- The LED lights up when the wireless communication connection is completed.
- It will connect automatically when the paired device is nearby. When connecting to other device, turn off the unused devices or disconnect.
- If you can't communicate, check that the connector is firmly connected. If it still fails, check the scale settings, pairing and connected devices.

## 7. Wireless Communication

- Bluetooth devices is EC2832 (KAGA ELECTRONICS Co., Ltd.)/ Bluetooth 5.0 (Bluetooth® Low Energy)
- The effective range communication is 10 m or less in an unobstructed space.

If there is an obstacle such as a wall, the range of communication will be shorter.

- Interference may be caused near the following devices that use the 2.4 GHz frequency band, which is the same as for Bluetooth. Therefore, this device is not suited for uses that require reliability.

- Wireless LAN
- Bluetooth devices (such as mobile phones)
- Home appliances such as microwave ovens

## 8. Compliance

### 8-1. Compliance with FCC Rules

This device contains transmitter module FCC ID: 2A6NFEC2832

This device complies with part 15 of the FCC Rules. Operation is subject to the following two conditions:

(1) This device may not cause harmful interference, and (2) This device must accept any interference received, including interference that may cause undesired operation. (FCC = Federal Communications Commission in the U.S.A.)

FCC CAUTION: Changes or modifications not expressly approved by the party responsible for compliance could void the user's authority to operate the equipment. The antenna used for this transmitter must not be co-located or operating in conjunction with any other antenna or transmitter. This product is certified as type of the portable device with FCC Rules. To maintain compliance with RF Exposure requirement, please use within specification of this product.

### 8-2. IC

IC RADIATION EXPOSURE STATEMENT FOR CANADA

This device contains transmitter module IC: 28568-EC2832

This device complies with Innovation, Science and Economic Development Canada license-exempt RSS standards. Operation is subject to the following two conditions:

(1) This device may not cause interference.  
(2) This device must accept any interference, including interference that may cause undesired operation of the device.

Le présent appareil est conforme aux CNR Innovation, Sciences et Développement économique Canada applicables aux appareils radio exempts de licence. L'exploitation est autorisée aux deux conditions suivantes :

- 1) l'appareil ne doit pas produire de brouillage;
- 2) l'utilisateur de l'appareil doit accepter tout brouillage radioélectrique subi, même si le brouillage est susceptible d'en compromettre le fonctionnement.