

GP-16 The Printer Support for the AD-8127 Instruction Manual

The printer support is used to install the AD-8127 to GX-L/GF-L series and GP series balances made by A&D Company, Limited.

Applicable products: GX-L/GF-L series, GP series

Installing the printer and printer support

Step 1 Remove two screws on right side of the display case.

- Step 2**
- GX-L/GF-L series
Remove the terminal cover for the RS-232C interface (D-Sub 9 pin).
 - GP series
Remove the option cover and the rubber cover.

Step 3 Install the printer support beside the display unit using screws (M4x15W SEMS screws).

Step 4 Place the printer (AD-8127) on the printer support while holding open the hook.

- Step 5**
- GX-L/GF-L series
Connect the RS-232C cable (AX-KO2741-100). Connect its RS-232C connector to the display unit and to the printer.
 - GP series
Connect the RS-232C cable (AX-KO2116-090). Connect its 25 pin connector to the display unit and its 9 pin connector to printer.

Step 6 Adjust the length of the remaining cable. Bundle up cables using cable clamps beside the display arm.

Step 7 Attach AC adaptor cables to the balance and printer, and bundle them using cable clamps.

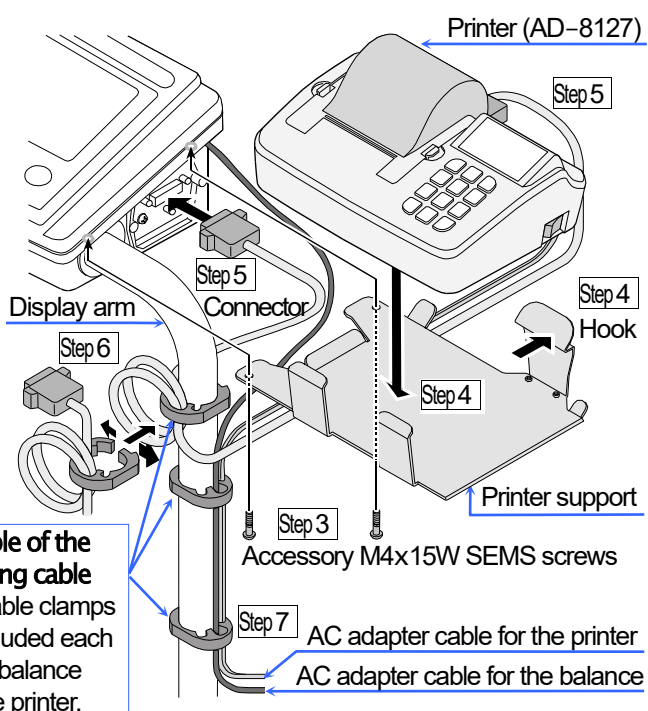
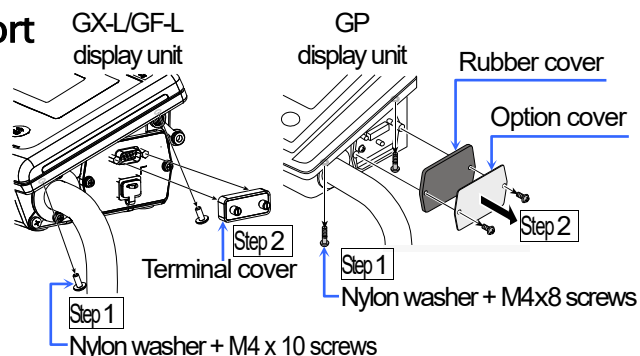

Example of the clamping cable
Two cable clamps are included each for the balance and the printer.

Caution

If the RS-232C interface terminal cover is removed from GX-L/GF-L series, or if the option cover and rubber cover are removed from GP series, the balance and printer will not be waterproof and dustproof.

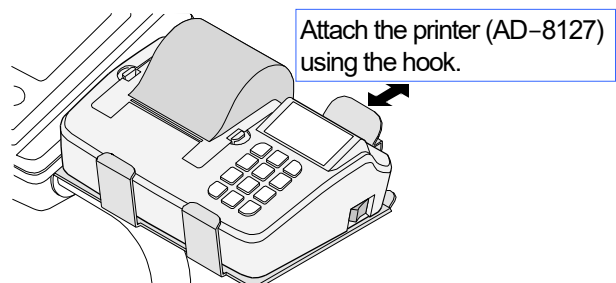

Packing Contents

Component parts	Quantity
GP-16 Printer support for the AD-8127	1
Cable clamp	2
M4 x 15W SEMS screws	2
Instruction manual (This document)	1

