

# SAMPLE CUP HOLDER (AX-HOLDER-SET-B) INSTRUCTION MANUAL

## 1. Product structure

The sample cup holder is a set of three pieces.

Parts structure	Quantity
Sample cup holder- large size (AX-HOLDER-L)	1 pc
Sample cup holder- medium size (AX-HOLDER-M)	1 pc
Sample cup holder- small size (AX-HOLDER-S)	1 pc

## 2. How to use

The sample cup holders are used to weigh test tubes, micro tubes, flasks or vials containing reagents or samples. The holders can be placed on a balance and used to secure a tilted container for measurement. Also the holders can be turned over and used to secure a long test tube as well.

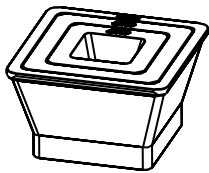

Three sample cup holders stacked

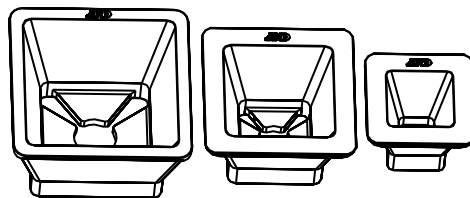

Large size    Medium size    Small size

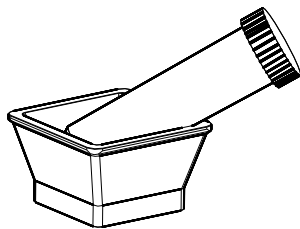

Centrifuge tube secured slantingly

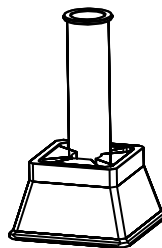

Sample cup holder used as test tube stand

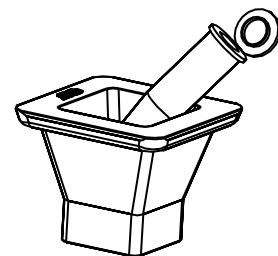

Sample cup holder used as holder for micro tube

## 3. Specifications

Mass (Large, medium and small)	Large size: 45 g, medium size: 32 g, small size: 16 g (When combined: Approx. 93g)
External dimensions (mm)	Large size: 67(W) × 67 (D) × 40 (H), medium size: 56(W) × 56 (D) × 36 (H), small size: 40(W) × 40 (D) × 32 (H)
Material	Electrically conductive rubber (Antistatic specification)

\* The large size sample cup holder allows weighing up to 150 g when an analytical balance with a weighing capacity of 200g is used.