

FXi-08 Ethernet Interface

A&D Company, Limited

When this Ethernet interface (FXi-08) is installed into the A&D balances such as FX-i, FZ-i, HR-A, HR-AZ, GX-A and GF-A, the balances can communicate with a computer through the LAN port and the weighing data can be managed with the software "WinCT-Plus".

Unpacking the Ethernet Board

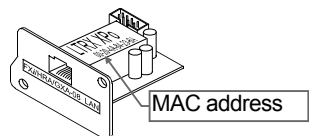

FXi-08
Ethernet Interface board

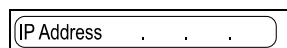

IP address label (5 labels)
Write the IP address on a label and use it for identification.

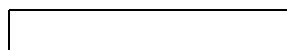

IP address protective cover (5 covers)
Affix a protective cover over the IP address label.

Installing the Ethernet Board

Caution: Remove the AC adapter from the balance before doing the following work.

Step 1 Record the MAC address* (Hardware address) printed on the **FXi-08** (Shown in the illustration). The MAC address is required when specifying the IP address.

* Example: 00-20-4A-84-23-6A

Step 2 Unfasten the two screws from the rear of the balance and remove the panel. Peel the connector off that is attached on the panel with double-side adhesive tape.

Step 3 Connect the connector to the **FXi-08**.

Step 4 Install the **FXi-08** in the balance and secure it using the two screws in step 2.

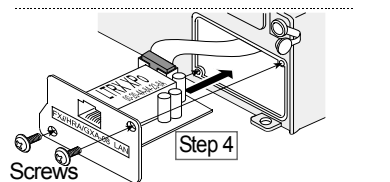
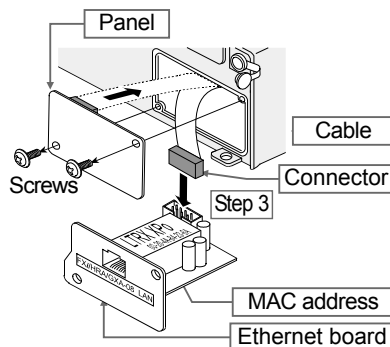

Connecting the Ethernet Board to a Computer

Caution

- Contact the network manager before connecting the **FXi-08** to a network. A network error may occur due to the **FXi-08**. A&D and dealers assume no responsibility for errors.
- Preset the IP address and subnet mask into the **FXi-08** one by one. The IP address, **172.16.100.2**, is set for all **FXi-08** at the factory. Do not duplicate IP addresses.
- The IP address cannot be restored to factory setting. We recommend that you write the IP address on the supplied label.

Preparation

Please download each software from A&D website (<https://www.aandd.jp/products/software/software.html>) for below.

- Setting procedure "WinCT-Plus" instruction manual
- IP address setting software "Device Installer"
- Data acquisition software "WinCT-Plus"

Step 1 Connect the Ethernet board and the computer using a hub and straight cables. (When connecting directly without using a hub, use a cross cable)

Step 2 Reconnect the AC adapter to the balance.

Step 3 Preset the IP addresses and subnet mask of the **FXi-08** and the computer. For the setting procedure, refer to the "WinCT-Plus" instruction manual.

A communication error may occur with the wrong operation.

Step 4 Write the IP address on "IP address label" and affix it where you can see the address easily.

Step 5 Install the data acquisition software to refer to the "WinCT-Plus" instruction manual.

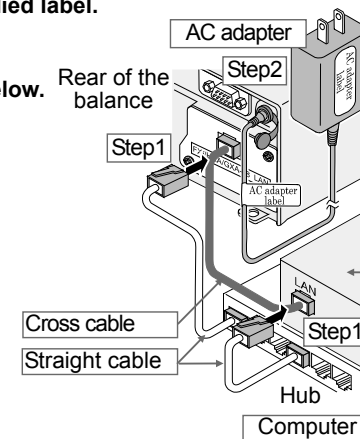

The Outline for Windows Communication Software

Run the data acquisition software "RsMulti". Menu: [Start] → [Program] → [A&D WinCT-Plus] → [RsMulti]. Refer to the [A&D WinCT-Plus] → [Manual (for the OP-08)] for the operation.

- The software can acquire data from multiple devices connected with a LAN or RS-232C.
- The software can control these devices with commands.
- The software can acquire data transmitted from devices. Example: When the **PRINT** key of the balance is pressed, data is output and is acquired with the computer.
- The stored data can be used with the Microsoft EXCEL, when it is installed before use.
- Up to 100 weighing instruments can be connected. However, the number of connections may be restricted depending on the computer's performance and the frequency of data acquisition.

A sample window of the "RsMulti"

Example

Two balances are connected.

	IP address	Subnet mask
Computer	172.16.100.1	
FX-300i	172.16.100.2	255.255.0.0
FX-3000i	172.16.100.3	

